

# 511183

## PARTS BREAKDOWN

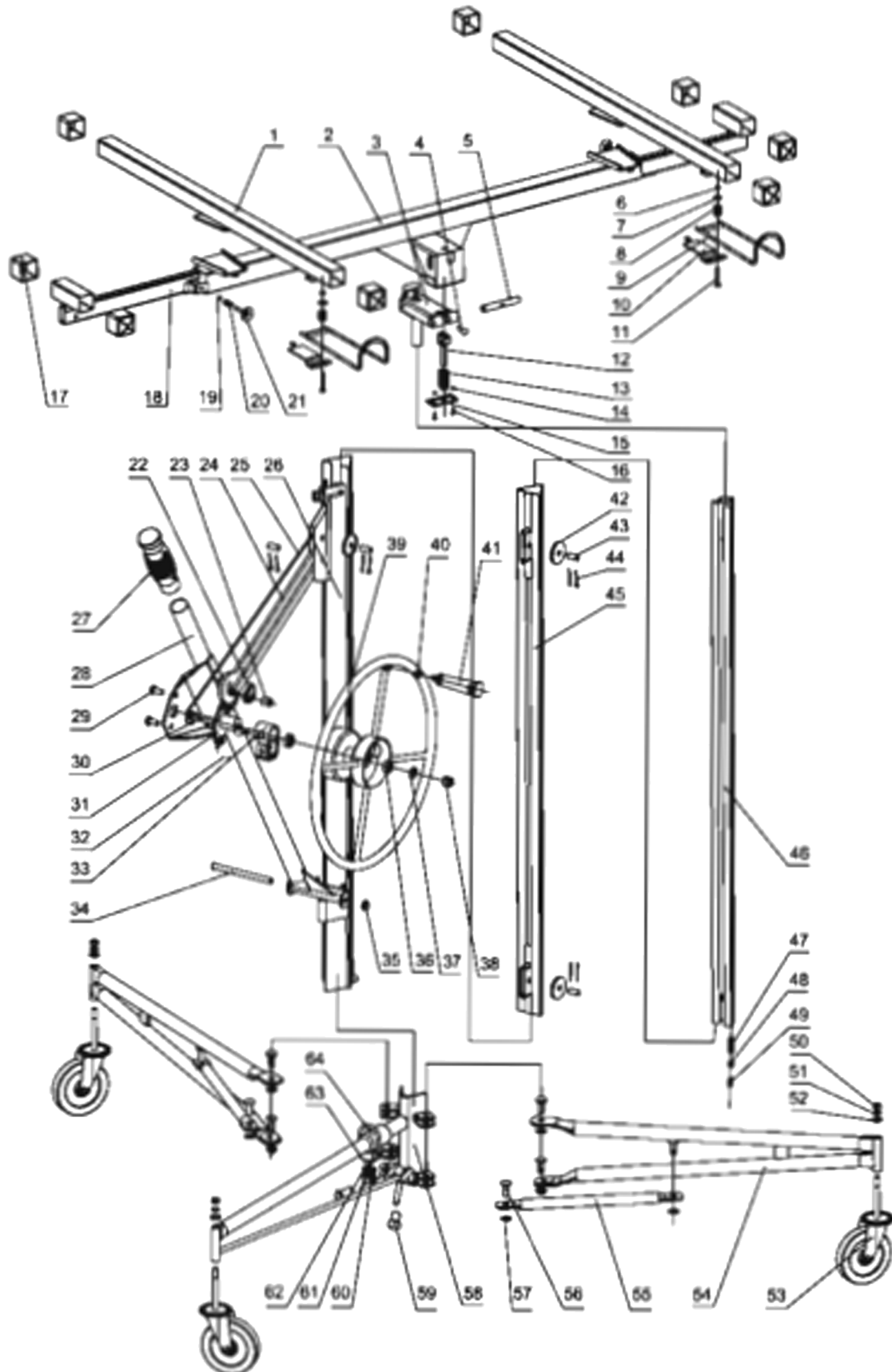

Component	Item Description
<a href="#"><u>501091</u></a>	Crossarm Cap To Suit Wallboard Panel Hoist Lifter Model 511183
<a href="#"><u>501096</u></a>	Handle Replacement To Suit Wallboard Panel Hoist Lifter Model 511183
<a href="#"><u>501093</u></a>	Wire Replacement Cable To Suit Wallboard Panel Hoist Lifter Model 511183
<a href="#"><u>501094</u></a>	Roller Replacement To Suit Wallboard Panel Hoist Lifter Model 511183
<a href="#"><u>501092</u></a>	Castor To Suit Wallboard Panel Hoist Lifter Model 511183
<a href="#"><u>501095</u></a>	Pin & Split Pins for Rollers To Suit Wallboard Panel Hoist Lifter Model 511183

# 511183

## PARTS BREAKDOWN



Serial NO.	Description	Specification	Quality
1	supporting rod of the main bracket		2
2	hex-nut	M6 x 1	3
3	supporting rod		2
4	spring press plate		2
5	tube cap 2		8
6	spring press plate		2
7	flat washer	6N	2
8	hex-bolt	M6 x 35	2
9	tube cap 2		2
10	washer	6N	2
11	reset spring		2
12	T-pin		2
13	adjusting spring		1
14	hex-bolt	M6x25	1
15	spring rod		1
16	spindle		1
17	cross-bar		1
18	assistant bracket		2
19	hex self-locking nut	M6	6
20	steering gear base		1
21	hex-bolt	M6x60	1
22	safe lock		1
23	hex-bolt	M6x10	2
24	press plate		1
25	ox-horn		1
26	diagonal draw bar		1
27	unadjustable bolt		1
28	rubber sleeve		1
29	brake handle		1
30	hex-nut	M12	2
31	hex-bolt	M10x20	2
32	pull spring		1
33	hex-bolt	M12x120	1
34	side plate		1
35	flat washer	12N	1
36	round handle		1
37	rubber round handle		1
38	brake rubber handle		1
39	positioner		1
40	exciter shaft fixed plate		1
41	hex-nut	M10	1
42	hex-bolt	M10x150	1
43	wheel with brake	5"	3
44	main supporting bracket		1
45	split pin	2.5 x 18	12
46	sliding lock		1
47	spring plate		2
48	hex-bolt	M6x14	2
49	reset spring		1
50	supporting bracket		2
51	assistant bracket		2
52	inner pillar		1
53	middle pillar		1
54	guide wheel		3
55	shaft pin		4
56	flat washer	10 N	12
57	hex-bolt	M10X35	2
58	outer pillar		1
59	wire rope lock		1
60	wire rope	4mm	1