

# 595947 ELECTRIC DRILL BIT SHARPENER

**TOOLEX<sup>®</sup>**  
**Industrial**



## INSTRUCTION MANUAL



## CONTENTS



1. Specifications .....	2
2. Symbols .....	2
3. General Safety Rules .....	3
4. Operation .....	4
5. Installation Of Dust proof Cover .....	6
6. Cleaning .....	6
7. Parts List.....	7



## 1. SPECIFICATIONS

Model Number	595947
Volt/Frequency	240V/50Hz
Input Power	80W
Max. Speed	4200 RPM
Sharpening Size	1/8" - 17/32" (3mm - 13mm)
Sharpening Wheel Size	60mm Diameter, 80grit
Net weight	2.95kg

## 2. SYMBOLS

	<b>Danger</b>	Indicates an imminently hazardous situation which, if not avoided, will result in death.
	<b>Warning</b>	Indicates a potentially hazardous situation which, if not avoided, could result in death or serious injury.
	<b>Caution</b>	Indicates a potentially hazardous situation which, if not avoided, may result in minor or moderate injury.

	Warning
	Read the Instruction manual
	Wear eye protection, ear muffs and helmet

	Wear foot protection
	Wear gloves

## Save This Manual

You will need the manual for the safety warnings and cautions, assembly instructions, operating procedures, maintenance procedures, trouble shooting, parts list, and diagram.

## Safety Warning & Cautions

**WARNING:** When using electric tools, machines, or equipment, basic precautions should always be followed to reduce the risk of fire, electric shock, and personal injury.

## 3. GENERAL SAFETY RULES

### Read All Instructions Before Using This Tool!

1. **KEEP WORK AREA CLEAN.** Cluttered areas invite injuries.
2. **OBSERVE WORK AREA CONDITIONS.** Do not use machines or power tools in damp, wet, or poorly lit locations. Don't expose to rain. Keep work area well lit. Do not use electrically powered tools in the presence of flammable gasses or liquids.
3. **KEEP CHILD AWAY.** Children must never be allowed in the work area. Do not let handle machines, tools, or extension cords.
4. **STORE IDLE EQUIPMENT.** When not in use, tools must be locked up in a dry location to inhibit rust. Always lock up tools and keep out of reach of children.
5. **DO NOT FORCE THE TOOL.** It will do the job better and more safely at the rate for which it was intended. Do not use inappropriate attachments in an attempt to exceed the tool's capacities.
6. **USE THE RIGHT TOOL FOR THE JOB.** Do not attempt to force a small tool or attachment to do the work of large industrial tool. Do not use a tool for a purpose for which it was not intended.
7. **DRESS PROPERLY.** Do not wear loose clothing or jewellery as they can be caught in moving parts. Protective, electrically nonconducting clothes and Non-slip footwear are recommended when working. Wear restrictive hair covering to contain long hair.
8. **USE EYE AND EAR PROTECTION.** Always wear ANSI approved chemical splash goggles when working with chemicals. Always wear ANSI approved impact safety goggles at other times. Wear a full face shield if you are producing metal filings or wood chips. Wear an ANSI approved dust mask or respirator when working around metal, wood, and chemical dusts and mists.
9. **DO NOT ABUSE THE POWER CORD.** Do not yank it to disconnect it from the receptacle. Do not carry tools by the cord.
10. **DO NOT OVERREACH.** Keep proper footing and balance at all times. Do not reach over or across running machines.
11. **MAINTAIN TOOLS WITH CARE.** Keep tools sharp and clean for better and safer performance. Follow instructions for lubricating and changing accessories. Inspect tool cords periodically and, if damaged, have them repaired by an authorized technician. The handles must be kept clean, dry, and free from oil and grease at all times.
12. **DISCONNECT POWER.** Unplug when not in use, before servicing, and when changing accessories.
13. **REMOVE ADJUSTING KEYS AND WRENCHES.** Make it a habit to check that keys and adjusting wrenches are removed from the tool or machine work surface before plugging it in.
14. **AVOID UNINTENTIONAL STARTING.** Be sure the switch is in the OFF position when not in use and before plugging in. Do not carry any tool with your finger on the trigger, whether it is plugged in or not.
15. **15. OUTDOOR EXTENSIONS CORDS.** When the equipment is operated outdoors, use only extension cords intended for outside use. See chart under Extension Cords': For the proper AWG rating depending on the length of the cord(s) being used.
16. **STAY ALERT.** Watch what you are doing, use common sense. Do not operate any tool when you are tired.
17. **CHECK DAMAGED PARTS.** Before using any tools, any part that appears damaged should be

carefully checked to determine that it will operate properly and perform its intended function. Check for alignment and binding of moving parts; any broken parts or mounting fixtures; and any other condition that may affect proper operation. Any part that is damaged should be properly repaired or replaced by a qualified technician. Do not use the tool if any switch dose not turn on and off properly.

18. **GUARD AGAINST ELECTRIC SHOCK.** Prevent body contact with grounded surfaces such as pipes, radiators, and refrigerator enclosures.
19. **REPLACEMENT PARTS AND ACCESSORIES.** When servicing, use only identical replacement parts. Use of any other parts will void the warranty. Only use accessories intended for use with this tool.
20. **DO NOT OPERATE TOOL IF UNDER THE INFLUENCE OF ALCOHOL OR DRUGS.** Read warning labels on prescriptions to determine if your judgment or reflexes are impaired while taking drugs. If there is any doubt, do not operate the tool.
21. **KEEP AWAY FROM LIQUIDS.** Tool is designed for dry sharpening operations only.
22. **BE CAREFUL OF BITS WHEN SHARPENING.** Bits will become hot. Be careful when handling; allow tips to cool for some time before storing.
23. **SHARPENING HEAD MAY BECOME HOT WHILE USING.** This is a normal condition and no cause for alarm. Be careful when handling.

### **Voltage Warning**

Common household current is 220V-240V volts. As long as your tool is rated from 220V-240V there will be no complications using this tool with household receptacles.

## **4. OPERATION**

### **FOR PART LISTING REFER TO PAGE 7**

1. Take hold 35# (Positioner for Blade), release 36# (Blade Holder) by turning 39# (Locknut). Put drill bit into 35# - Positioner For Blade (See Fig 1.)



Fig 1.

2. Press 2# (Button), make 4# (Spring Leaf) expands; (See Fig. 2) Put 40# (Hold Accessory) into 7# (Fixing Shelf), make 35#(Position for Blade) stuck in 7#(Fixing Shell) at correct position. (See Fig 3.)



Fig 2.



Fig 3.

3. Adjusting the drill bit position, make the top of drill bit touches 6# (Terminal) firmly, 4# (spring leaf) pinch the groove of drill bit  
(See Fig 4. & 5.)



Fig 4.

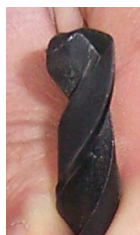

Fig 5.

4. Rotate 39# (Locknut), make 36# (Blade Holder) pinch the drill bit firmly
5. Pull out 40#(the Hold Accessory)and erecting it in 34#(Stand Socket). CAREFULLY make sure that the heave on 35# (Positioner for Blade) inserts in the groove on 34# (Stand Sockets) , move the Positioner for Blade from side by side, begin to sharpen. (See Fig 6.)  
Where there is no grinding sound between the grinding wheel and the drill, pull out 35# Accessory and turn it by 180°, and then conduct grinding; the procedure is the same as above mentioned.
6. Place 35# Accessory on the 14# Spacer, facing back angle of the drill, and turn 35# Accessory to the left and to the right; conduct grinding. On condition that no grinding sound between the grinding wheel and the drill, pull out 35# Accessory and turn it by 180°, and then conduct grinding; the procedure is same as above mentioned; the operation is finished. (See Fig 7.)



Fig 6.



Before Grinding

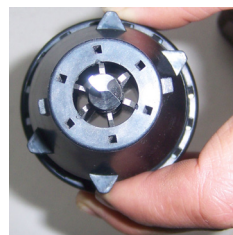

After Grinding



## 5. INSTALLATION OF DUST PROOF COVER

1. Ensure the dust proof cover (30#) is wedged into the base (28#) (See Fig A). Then make the dust proof cover(30#) level with three sides of the base (See Fig B)

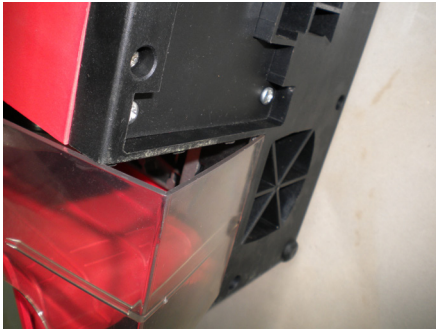

Fig A.

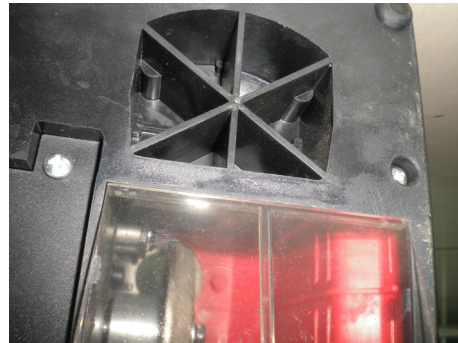

Fig B.

2. Push the dust proof cover (30#) forward the front cover (1#) direction. (See Fig C).



Fig C.



Fig D.

3. Make sure the buckle totally clip the cover. The installation is complete. (See Fig D).

Note: The machine can be operated only when it is grounded well. The machine can be started only when safety is ensured

Other objects or human body should not touch the grinding wheel to avoid accidents

## 6. CLEANING

1. Make sure to keep the surface of your unit free of grit, dirt, and grease. Use soapy water or non-toxic solvents. Do not use petroleum based solvents.
2. Keep the air vents free of foreign matter at all times.

## 7. PARTS LIST

Part No.	Description	Qty.
1	Top Housing	1
2	Button	1
3	Screw	2
4	Spring Leaf	2
5	Screw	2
6	Terminal	1
7	Fixing Shelf	1
8	Screw	2
9	Pad	1
10	Grinding Wheel	1
11	Connector	1
12	Screw	1
13	Screw	2
14	Positioner	1
15	Screw	2
16	Motor	1
17	Wire Restraining	1
18	Screw	2
19	Switch	1
20	PCB	1
21	Fuse Block	1
22	Nut for Fuse	1

Part No.	Description	Qty.
23	Fuse	1
24	Inductance	1
25	Locknut for Fuse block	1
26	Cover	1
27	Cushion	4
28	Base	1
29	Screw	11
30	Dust Cap	1
31	Cord	1
32	Connector Board	1
34	Screw	4
35	Bracket	1
36	Stand Socket	1
37	Positioner for Blade	1
38	Blade Holder	6
39	Steel Spring	6
40	Transition Tube	1
41	Locknut	1
42	Hold Accessory (Includes 35,36,37,38,39)	1
43	Chaffering Ring	1
44	Small Cover	1
48	Big Cover	1

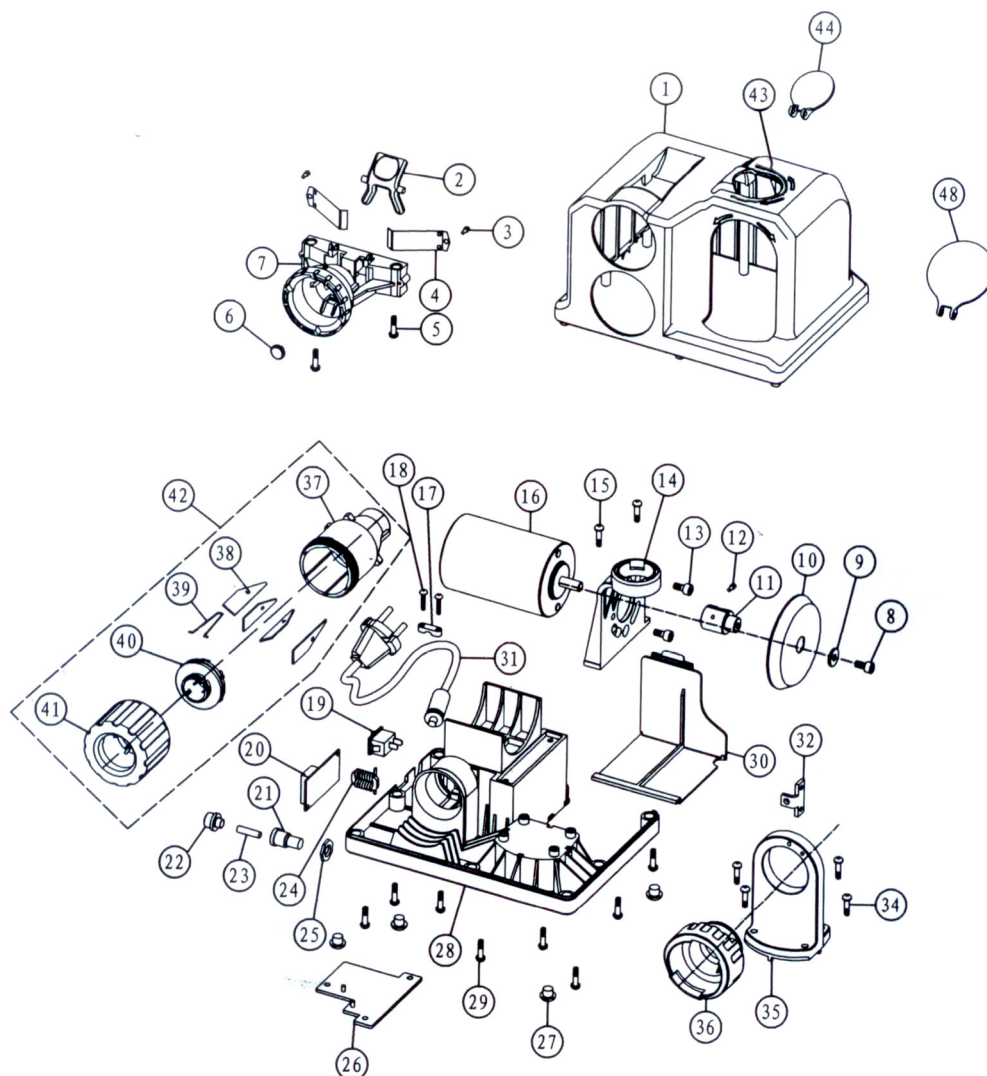

### **PLEASE READ THE FOLLOWING CAREFULLY**

THE MANUFACTURE AND/OR DISTRIBUTOR HAS PROVIDED THE PARTS DIAGRAM IN THIS MANUAL AS A REFERENCE TOOL ONLY. NEITHER THE MANUFACTURER NOR DISTRIBUTOR MAKES ANY REPRESENTATION OR WARRANTY OF ANY KIND TO THE BUYER THAT HE OR SHE IS QUALIFIED TO MAKE ANY REPAIRS TO THE PRODUCT OR THAT HE OR SHE IS QUALIFIED TO REPLACE ANY PARTS OF THE PRODUCT. IN FACT, THE MANUFACTURER AND/OR DISTRIBUTOR EXPRESSLY STATES THAT ALL REPAIRS AND PARTS REPLACEMENTS SHOULD BE UNDERTAKEN BY CERTIFIED AND LICENSED TECHNICIANS AND NOT BY THE BUYER. THE BUYER ASSUMES ALL RISK AND LIABILITY ARISING OUT OF HIS OR HER REPAIRS TO THE ORIGINAL PRODUCT OR REPLACEMENT PARTS THERETO. OR ARISING OUT OF HIS OR HER INSTALLATION OF REPLACEMENT PARTS THERETO

**CONSUMER SERVICE CENTRE**  
**PO BOX 1012**  
**HAMILTON NSW 2303 AUSTRALIA**  
**Made in P.R.C.**