

596829  
PARTS BREAKDOWN

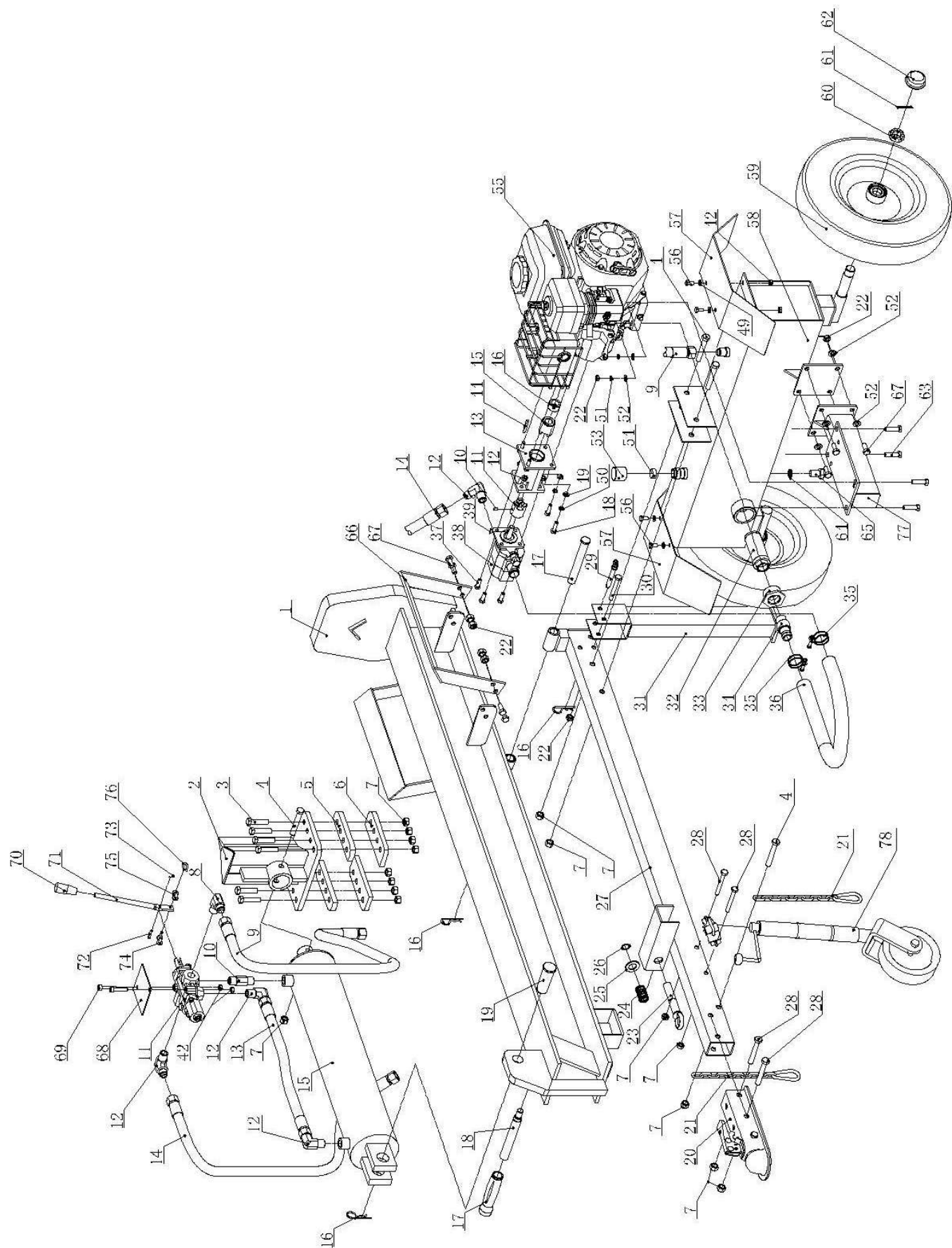

Component	Item Description
<a href="#">595777</a>	Log Splitter Gear Pump 45T For 596829
<a href="#">595761</a>	Log Splitter Cylinder 45T 5.5" Suit 596829
<a href="#">595769</a>	Log Splitter Cylinder Seal Set Suit 596829 45T Cylinder Part No 595761
<a href="#">596824</a>	Log Splitter Less Motor 13Hp Honda GX390QXU Suit 45Ton 5.5" Cylinder for 596829
<a href="#">595766</a>	Log Splitter Control Valve Suit 596828 and 596829 30T & 45T
<a href="#">595774</a>	Log Splitter Hoses Set For 30T & 45T 596828 and 596829
<a href="#">595775</a>	Log Splitter Fenders for 30T & 45T 596828 and 596829
<a href="#">595776</a>	Log Splitter Oil Tank Cap Suit 596827, 596828, 596829 18T 30T 45T

596829

## PARTS BREAKDOWN



No.	Name	QTY	No.	Name	QTY
1	Beam	1	40	Screw m6x10	1
2	Wedge	1	41	Gear Pump Connector	1
3	Hex Bolt m12x50	8	42	Lock Nut m8	16
4	Hex Bolt m12x75	1	43	Connector Stand	1
5	Wedge Spacer	2	44	Flat Key	1
6	Wedge Plate	2	45	Engine Connector	1
7	Lock Nut m12	14	46	Engine Bushing	1
8	1/2"-22x1.5 Connector	1	47	Beam Roll Pin	1
9	Oil Hose c	1	48	Hex Bolt m8x30	4
10	Pope Joint	1	49	Flat Washer ø8	24
11	Control Valve	1	50	Spring Washer ø8	8
12	1/2"-1/2"Connector	4	51	Spring Washer ø10	4
13	Oil Hose b	1	52	Flat Washer ø10	1
14	Oil Hose a	1	53	Oil tanke cap	1
15	Cylinder	1	54	Sponge filter	1
16	r Pin	4	55	Engine	4
17	Control Handle Cover	3	56	Hex Bolt m8x16	2
18	Control Handle	1	57	Wheel Guard	1
19	Cylinder Pin	1	58	Oil Tank	2
20	Tow 2in	1	59	16" Pneumatic Tire	2
21	Chain	2	60	Thin Slotted Nuts m24x2	2
22	Lock Nut m10	10	61	Cotter Pin ø4x36	2
23	Beam Lock Pin	1	62	Wheel Cap	1
24	Return Spring	1	63	Hex Bolt m10x40	1
25	Washer ø20	1	64	Busher ø16 O	2
26	Shaft Circlip ø19	1	65	Oil Drain Bolt m16x1.5	12
27	Tow Bar	1	66	Guide Plate	1
28	Hex Bolt m12x80	5	67	Hex Bolt m10x25	2
29	Pin	2	68	Plate support	1
30	Hex Bolt m10x75	2	69	Screw m8x40	6
31	Supporter	2	70	Handle Cover	2
32	Oil Filter 40x180-j	1	71	Control Valve	1
33	Nut Zg1 1/2	1	72	Pin 5x25b	1
34	Inlet Oil Hose Connector g1	1	73	Cotter Pin ø1.6x10	1
35	Hoop	2	74	Roller Chain	2
36	Suction Pipe	1	75	Chain Plat	2
37	Hex Bolt m8x25	4	76	Locker	1
38	Gear Pump	1	77	Engine Stand	8
39	Woodruff Key	1	78	Jockey wheel	1