

534120

LEVER PULLER-WIRE ROPE 1.6 TONNE

TOOLEX[®]
Industrial



INSTRUCTION MANUAL

PLEASE READ THESE INSTRUCTIONS CAREFULLY TO
ENSURE THE SAFE AND EFFECTIVE USE OF THIS TOOL.

CONSUMER SERVICE CENTRE
PO BOX 1012
HAMILTON NSW 2303 AUSTRALIA
Made in P.R.C.



SPECIFICATIONS

Part number	534120
Lifting Capacity	1600kg
Pulling Capacity.....	2400kg
Wire Rope Diameter	11mm
Nett Weight	12kg
Size.....	545 x 284 x 97mm
Overall handle Length	1200mm

GUARANTEE

Toolex Industrial have been carefully tested and inspected before shipment and are guaranteed to be free from defective materials and workmanship for a period of 12 months from the date of purchase except where tools are hired out when the guarantee period is ninety days from the date of purchase.

Should the machine develop any fault, please return the complete tool to your nearest authorised warrantly repair agent or contact Toolex Industrial PO Box 1012 Hamilton NSW, 2303 Australia or Telephone: (02) 4906 7700.

If upon inspection it is found that the fault occuring is due to defective materials or workmanship, repairs will be carried out free of charge. This guarantee does not apply to normal wear and tear, nor does it cover any damage caused by misuse, careless or unsafe handling, alternations, accident, or repairs attempted or made by any personnel other than the authorised Toolex warrantly repair agent.

This guarantee applies in lieu of any other guarantee expressed or implied and variations of its terms are not authorised.

Your Toolex guarantee is not effective unless you can produce upon request a dated receipt or invoice to verify your proof of purchase within the 12 month period.

Please note that this guarantee is an additional benefit and does not affect your statutory rights
Toolex Industrial.

GENERAL SAFETY INSTRUCTIONS

WARNING:

Please read the following instructions carefully, failure to do so could lead to serious personal injury. When using tools, basic safety precautions, including the following, should always be followed to reduce the risk of personal injury. Read all these instructions before operating this product and save these instructions.

IMPORTANT:

Toolex Industrial recommends that this item should not be modified or used for any application other than that for which it was designed. If you are unsure of its relative applications do not hesitate to contact us in writing and we will advise you.

1. Do not exceed the maximum specified capacity.
2. Do not use in the vicinity of children or animals.
3. Take care when moving hoist as the the unit is heavy.
4. Wear safety equipment during operation.
5. Do not feed the wire rope from the wrong end.
6. Do not use any other device as a lever. Only use the handle supplied.
7. Never operate the release lever while the hoist is under load.
8. Do not operate both levers simultaneously.
9. Never stand or work on or under the item being lifted/pulled.
10. Do not use the hoist if it or the rope is damaged.
11. Do not let the load twist severely or swing during lifting.
12. Only use the manufacturer's own choice rope with the correct capacity for the hoist.

IMPORTANT NOTE:

Residual Risk. Although the safety instructions and operating manuals for our tools contain extensive instructions on safe working with tools, every tool involves a certain residual risk which can not be completely excluded by safety mechanisms. All tools must therefore be operated with caution!

GETTING TO KNOW YOUR WIRE ROPE PULLER

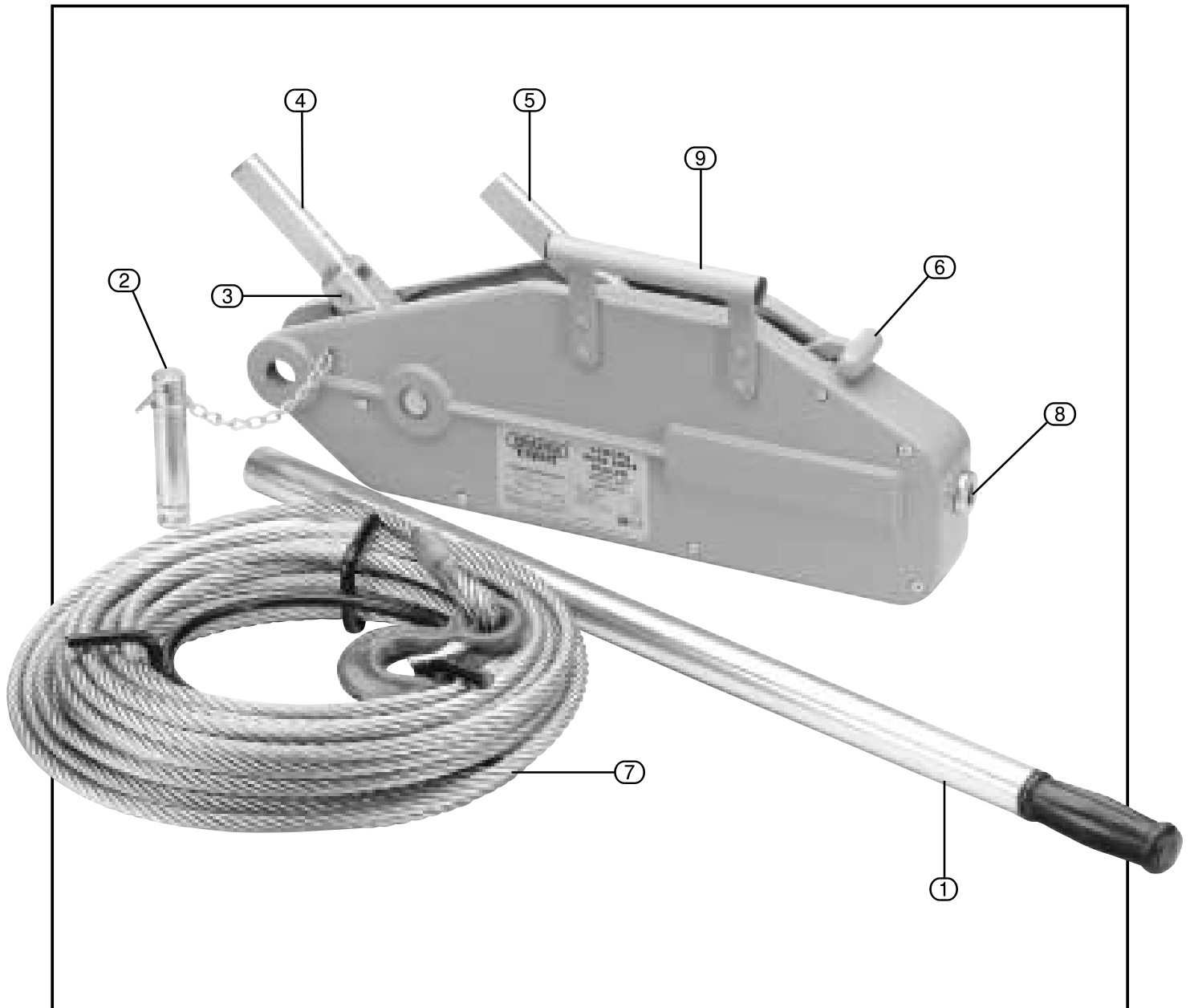

- | | |
|----------------------------|-----------------------|
| ① Extendable Handle | ⑥ Release Lever |
| ② Anchor Pin | ⑦ Wire Rope with Hook |
| ③ Overload Sheer Pin | ⑧ Feed Guide |
| ④ Forward Direction Handle | ⑨ Carry Handle |
| ⑤ Reverse Direction Handle | |

UNPACKING: After removing the packing material, make sure the product is in perfect condition and that there are no visible damaged parts. If in doubt, do not use the Wire Rope Puller and contact the dealer from whom it was purchased.

The packaging materials (plastic bags, polystyrene etc.,) must be disposed of in an appropriate refuse collection container. These materials must not be left within the reach of children as they are potential sources of danger.

ASSEMBLY

NOTE:

Take care when lifting, as the hoist is heavy.

FEEDING IN THE ROPE: (Fig.1)

Note: For the first 10 to 15 operations, the release lever (A) will be difficult to operate. This is normal and will ease with use. Place handle (B) & (C) into the forward position. Slide and lock the release lever (A) into forward position. This will open the internal jaws for the wire rope to be inserted through the feed guide (D). When resistance is felt, pull back and unlock release lever (A) and the feed can be taken up on the handle.

Note: Never feed the wire rope through from the other side.

ANCHOR PIN FITTING: (Fig.2)

The hoist should be secured to a suitable point which will sustain the capacity load. The strop, chain or other anchor fixing must also be able to sustain the capacity load. Pass the anchor pin (E) through the housing. Due to the securing method (G), the pin will require rotating to insert further and rotated and pushed once more to fully lock in place. If required, for additional safety, the pin is equipped with a small hole (F) to accept an appropriate sized clevice pin (not supplied).

Fig.1.

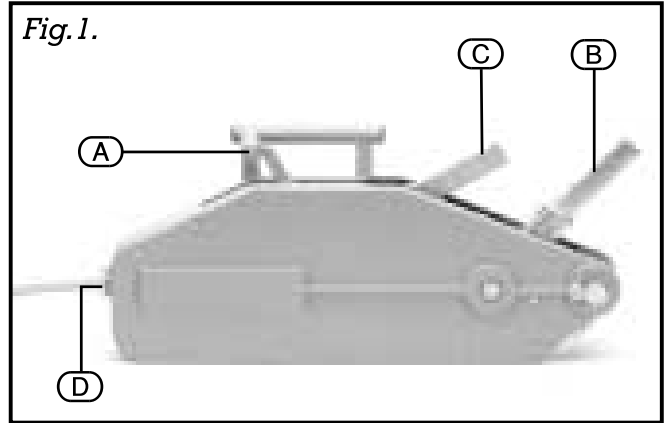
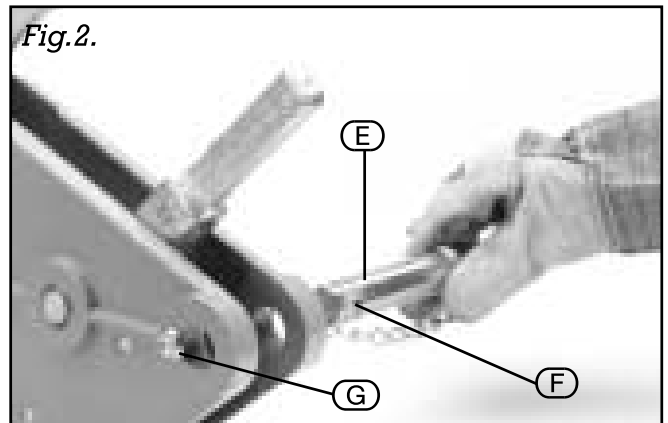

Fig.2.



OPERATION & USE

FORWARD OPERATION: (Fig.3)

With the wire rope loaded in place, lock the extendable handle onto lever (H) by locating the pin and twisting. Moving the handle back and forth will pull the wire rope through the hoist.

Note: For safety reasons, the lever is equipped with a sheer pin. If the load being attempted exceeds capacity, the pin will break and require replacing

Fig.3.

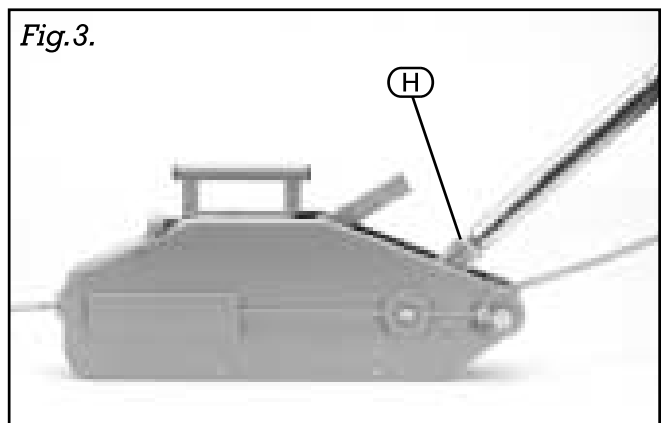

OPERATION & USE

REVERSE OPERATION: (Fig.4)

With the wire rope loaded in place, lock the extendable handle onto lever ① by locating the pin and twisting, moving the handle back and forth will push the wire rope back through the hoist.

Note: To remove the rope fully, the release lever must be locked forward.

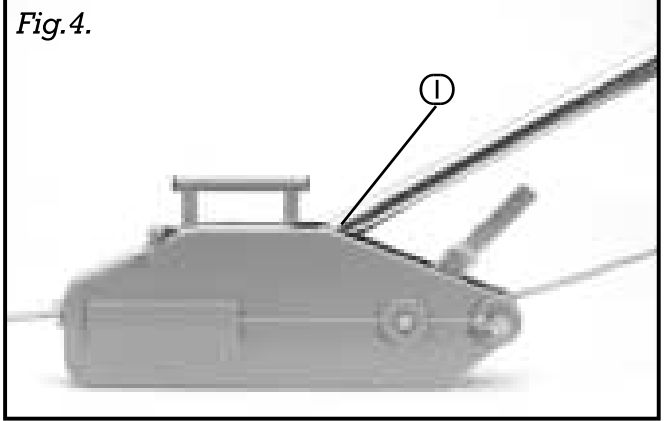

PARTS BREAKDOWN

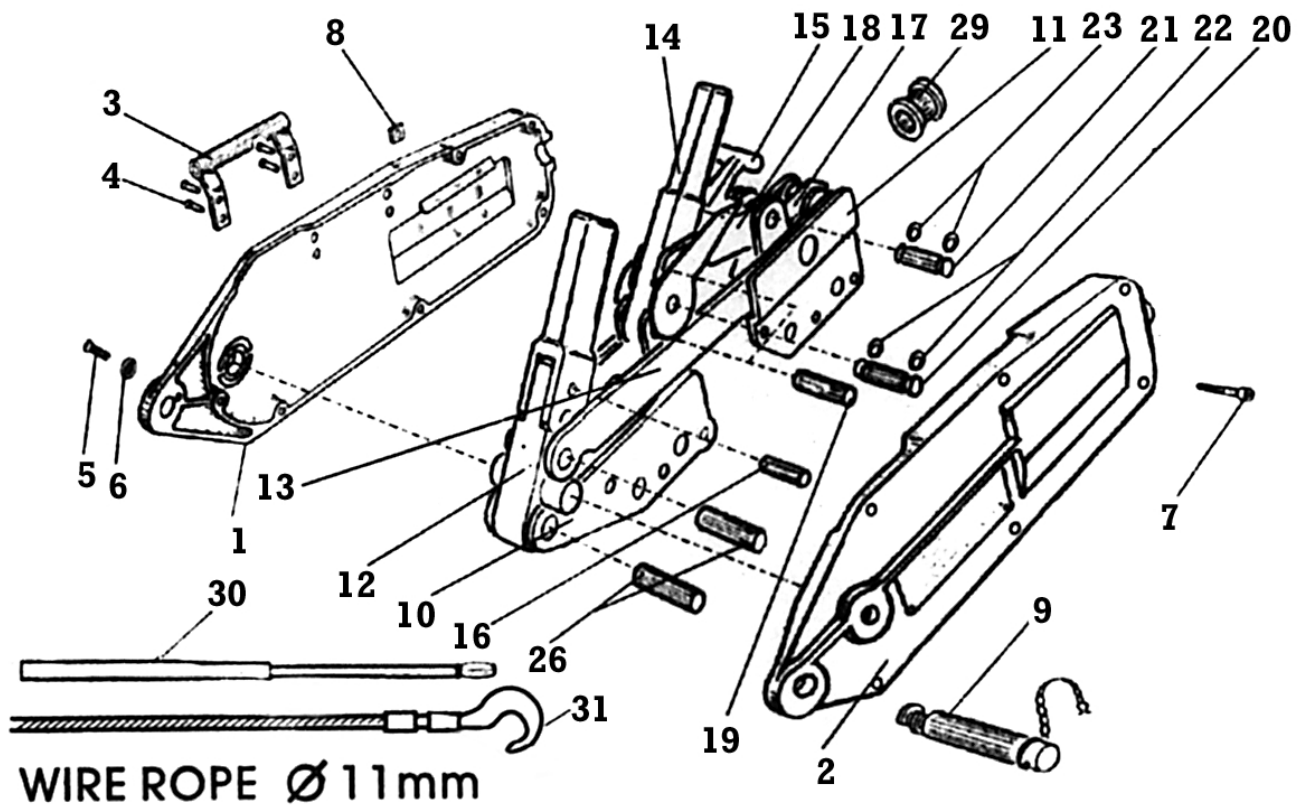

PARTS LIST

KEY No.	PART No.	DESCRIPTION
1	YWRP1-01	Left hand plate
2	YWRP1-02	Right hand plate
3	YWRP1-03	Handle
4	YWRP1-04	Rivet
5	YWRP1-05	Hex-Washer
6	YWRP1-06	Spring Washer
7	YWRP1-07	Hex-Bolt
8	YWRP1-08	Hex-Nut
9	YWRP1-09	Anchor bolt
10	YWRP1-10	Front Jaw Block
11	YWRP1-11	Back Jaw Block
12	YWRP1-12	Forward handle
13	YWRP1-13	Long Connecting Rod
14	YWRP1-14	Reverse handle
15	YWRP1-15	Relax lever
16	YWRP1-16	Safety bolt
17	YWRP1-17	Upper grip jaw
18	YWRP1-18	Connecting rod

KEY No.	PART No.	DESCRIPTION
19	YWRP1-19	Pin
20	YWRP1-20	Pin
21	YWRP1-21	Pin
22	YWRP1-22	Bush
23	YWRP1-23	Bush
26	YWRP1-26	Connect rod
29	YWRP1-29	Guide tube
30	YWRP1-30	Extendable handle
31	YWRP1-31	Wire Rope W/Hook